

# Game Night Agenda – Lutheran St. Charles

Please see the information below regarding your visit to LHS.

Visiting Team Arrival: Visiting team busses and any accompanying vehicles will be directed to park in the lot above the stadium. Our faculty supervisor will meet your bus and direct you to your locker room.

Locker Rooms: The visitor's locker room is located on the corner of the building adjacent to the stadium. See attached map. The locker room is locked during the game please secure all valuables.

Officials: Will dress in the PE Locker Rooms adjacent to the gym down the athletic hallway.

Press Box: There will be a maximum of three team personnel allowed in the press box.

Turf Rules: During contests, only team personnel are allowed into the stadium, no parents or spectators!

- When entering the field, cross the track on the designated crosswalks.
- No drinks allowed on the field at any time...only water
- No food of any kind is allowed
- No chewing gum
- No sunflower seeds
- Please remove any trash on your sideline following the contest

*It is our goal is to ensure a consistent and attractive playing surface, to promote player's safety and to protect the artificial turf system. Please help us and the long-term playability of our field.*

Please send your rosters to [ewilson@lhssc.org](mailto:ewilson@lhssc.org).

## Lutheran High School Campus

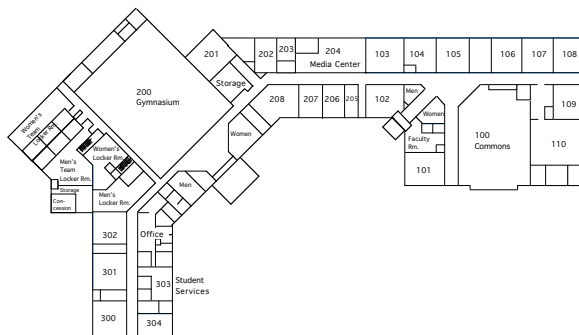
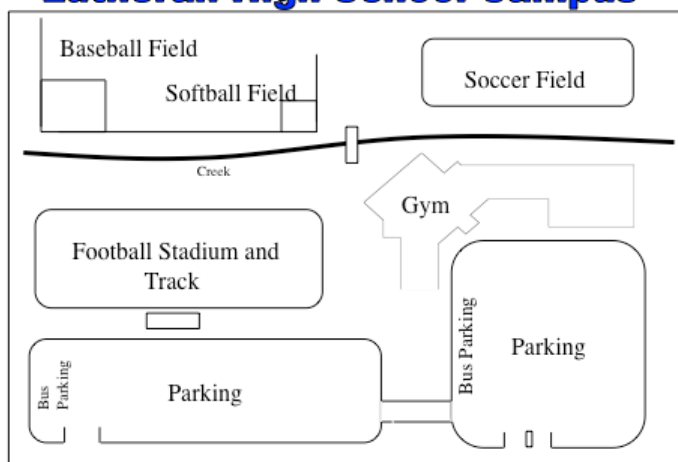

If you have any questions or concerns, please contact one of our building administrators

Principal – Jon Bernhardt

(636) 237-3465

[jbernhardt@lhssc.org](mailto:jbernhardt@lhssc.org)

Activities Director – Doug Kuhlmann

(314) 497-3014

[dkuhlmann@lhssc.org](mailto:dkuhlmann@lhssc.org)